



BSI CYLINDRICAL LOCKSET

BSI offer a wide range of highly durable and stylish cylindrical locksets ideal for standard to extra heavy-duty applications in commercial, industrial and institutional facilities. A wide variety of functions and trim provides flexibility to meet needs throughout the facility.

5100 SERIES GRADE 1 LEVERSET



GRADE 1



Underwriters Laboratories Inc.®



General Feature

1. 5100 Standard - Certificated by ANSI A156.2-2003.
2. UL listed - Meet UL 3 hours fire rating.
3. 6-Pin cores with the capacity to retrofit all 6-Pin best style locksets.
4. Wide variety of compatible locksets for other famous brands like Schlage, Arrow, Best, Falcon & KSP.
5. Standard Specifications:
 - (1) Lever: zinc, 125mm(From Lock center to Lever end)
 - (2) Rose: Φ 90mm.
 - (3) Door thickness: 35mm~51mm(1"-3/8 ~ 2")
 - (4) Backset: 60mm or 70mm
 - (5) Concealed Screws: The screws are hidden (concealed), not exposed at exterior side.
6. Cltch Function: The exterior lever have releasing to prevent heavy impact while pressing the lever at locking position.
7. Roller Retractor: The Retractor equipped with roller to enhance the mechanical reliability & durability.
8. Finish: US26D, US32D

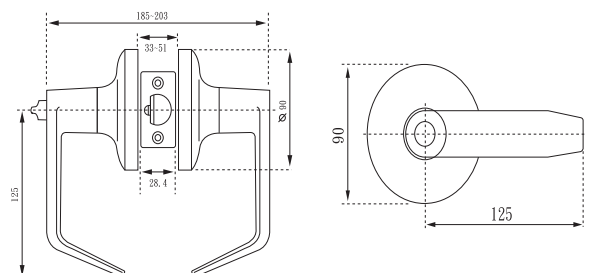

5100 GRADE 1 ELECTRIC LEVERSET



GRADE 1



Underwriters Laboratories Inc.®



5100-S ELECTRIC LOCKSET WITH SOLENOID

STANDARD WIRING
Dual Coil Solenoid

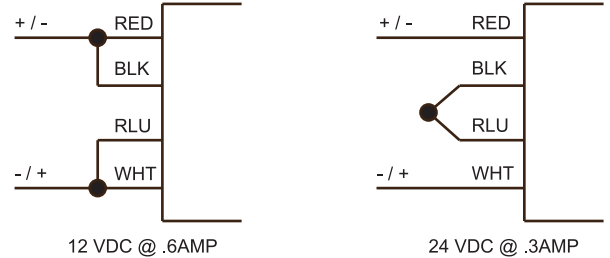

5100-M ELECTRIC LOCKSET WITH MOTOR

MORTOR SPEC. SHEET

No Load		Rated Load		Starting Torque (g-cm)	End Play	Output Shaft	Shaft Direction	Ansi-Static
Speed (r.p.m)	Current (mA)	Speed (r.p.m)	Current (mA)					
16400	<40	12000	<175	>10.5	0.05~0.30	4.0±0.2	CCW	250V 10MΩ

5200 SERIES GRADE 2 LEVERSET



GRADE 2



Underwriters Laboratories Inc.®



General Feature

- 5200 Standard - Certificated by ANSI A156.2-2003.
- 6-Pin cores with the capacity to retrofit all 6-Pin best style locksets.
- Wide variety of compatible locksets for other famous brands like Schlage, Arrow, Best, Falcon & KSP.
- Standard Specifications:
 - (1) Lever: zinc, 116mm(From Lock center to Lever end)
 - (2) Rose: Φ 85mm.
 - (3) Door thickness: 35mm~51mm(1"-3/8 ~ 2")
 - (4) Backset: 60mm or 70mm
 - (5) Concealed Screws: The screws are hidden (concealed), not exposed at exterior side.
 - (6) Clutch: Clutch function for outside Lever to prevent damage.
- Inside knob lever is always free to exit.
- Easy to install without necessity to drill two holes on the door.
- The tolerance of each part is very precise, the wavering condition is hardly seen.
- Finish: US26D, US32D

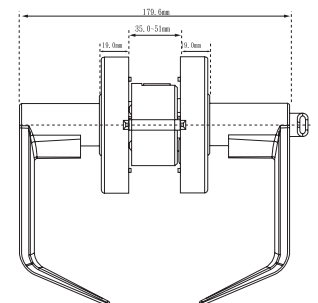
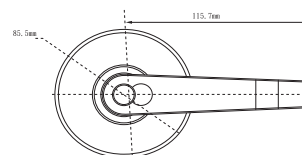



FUNCTION:

BSIM ODEL	ANSI		BSIM ODEL	ANSI	
5100FL 5200FL	F109	ENTRANCE LOCK Dead locking latch bolt operated by lever from either side except when outside lever is locked by the push or turn button inside. Key outside or operating inside lever releases push or turn button unlocking outside lever except when push or turn button has been rotated to keep outside lever locked. Inside push or turn button must be manually operated to unlock outside lever. Inside lever always operates latch bolt.	5101FL 5201FL	F82	ENTRANCE / OFFICE LOCK Dead locking latch bolt operated by lever from either side except when outside lever is locked by push button or other locking device on inside. When outside lever is locked, operating key in outside lever or operating inside lever unlocks push button or other locking device and retracts latch bolt. Closing door does not release push button or other locking device.
5102FL 5202FL	F90	CORRIDOR LOCK Dead locking latch bolt operated by lever from either side except when outside lever is locked by key in outside lever or by push button or other locking device on inside. Key in outside lever locks or unlocks outside lever. Operating inside lever releases push button or other locking device placed position. Closing door releases push button or other inside locking device. Inside lever always operates latch bolt.	5111FL 5211FL	F91	DOUBLE CYLINDER LOCK Dead locking latch bolt operated by lever from either side except when both levers are locked by turning key from either side. Latch bolt is automatically dead locked when door is closed.
5112FL 5212FL	F84	CLASSROOM LOCK Dead locking latch bolt operated by lever from either side except when outside lever is locked from outside by key. Inside lever always operative.	5114FL 5214FL	F80	COMMUNICATING LOCK Dead locking latch bolt operated by lever from either side. Turning key in either lever locks or unlocks its own lever independently.
5115FL 5215FL	F110	INTRUDER CLASSROOM LOCK Dead locking latch bolt operated by lever from either side. Key either inside or outside locks or unlocks outside lever. Inside lever always operates latch bolt.	5130FL 5230FL	F76	PRIVACY LOCK Latch bolt operated by lever from either side. Outside lever is locked by push button or other locking device inside and unlocked by emergency release outside, operating inside lever or closing door.
5151FL 5251FL	F113	COMMUNICATING (KEY TYPE) LOCK Locks or unlocks by key from inside only. Outside is a blank plate only.	5152FL 5252FL	F111	COMMUNICATING (NON-KEY TYPE) LOCK Latch bolt operated by lever from inside only. Outside is a blank plate only.
5161FL 5261FL	F87	DOUBLE STOREROOM LOCK (NON - CLUTCH) Dead locking latch bolt operated by key in levers, from either side. Both levers always inoperable.	5162FL 5262FL	F86	STOREROOM LOCK Dead locking latch bolt operated by key in outside lever, or by operating inside lever. Outside lever is always inoperable.
5178FL 5278FL		DUMMY SCREWS Dummy trim for one side of door. Used for door pull or as matching inactive trim. Lever and rose attached by two wood screws.	5279FL		DUMMY SCREWS Dummy trim for one side of door. Used for door pull or as matching inactive trim. Lever and rose attached by two thru bolt from the other side.

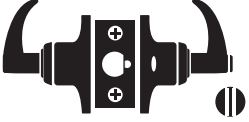

FUNCTION:

BSIM ODEL	ANSI	BSIM ODEL	ANSI
5182FL	5282FL	F75	PASSAGE
		Latch retracted by knobs/levers at all times	
		5190FL	PATIO LOCK
			
		Dead locking latch bolt operated by lever from either side. Outside lever is locked by push button or other locking device inside and unlocked by operating inside lever or closing door.	

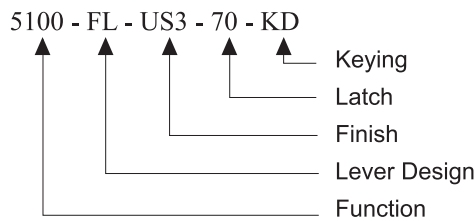

Trim Type	FL - Flat Lever CL - Curve Lever KB - Knob
Latch	60 or 70mm Backset
Keying	KA, KD, CK, MCK MK, GMK, GGMK

EXPLODED VIEW:

